

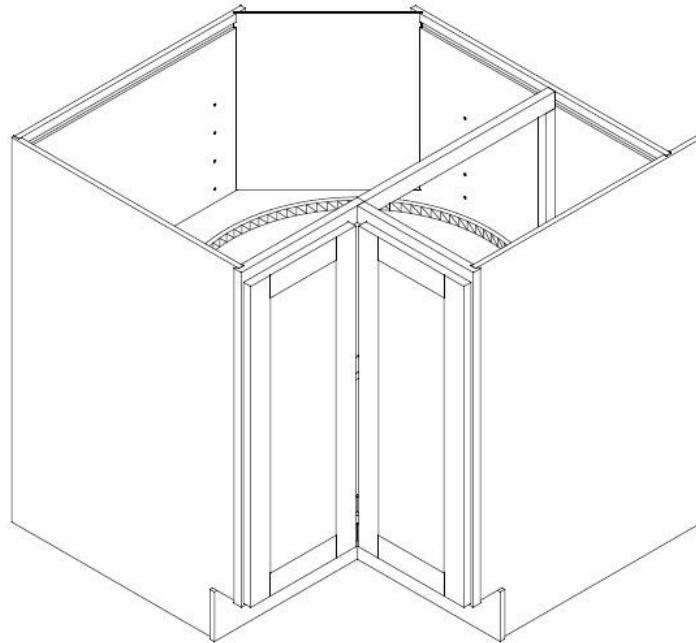

MALIBU WHITE ASSEMBLY INSTRUCTIONS



These assembly instructions are applicable for all base reach Lazy Susans ONLY

ITEM No.: CB33WH,CB36WH

► **General Instructions:**

Thank you for choosing a B.JORGSEN & CO. product. You are now the proud owner of a high quality product designed to face the test of daily use and guaranteeing your enjoyment for many years to come.

Carefully read the instructions before starting the installation.

During assembly, please follow all generally accepted safety procedures.

Failure to adhere to the following instructions will invalidate the warranty and B.JORGSEN & CO. declines any responsibility for any damages caused. Any installation which does not correspond to the instructions may result in defects, malfunctioning parts, significant damage and/or injury.

Before the assembly begins, check that all appropriate and required plumbing and electrical connections exist.

Before drilling, make absolutely sure that there are no pipes (gas, water, electricity, heating, etc.) at the drilling location. B.JORGSEN & CO. will not be held responsible for failure to follow these instructions.

PRIOR TO ASSEMBLY, PLEASE MAKE SURE YOU HAVE ONE FACE FRAME BOX AND ONE CARCASS BOX, WHICH HAVE ALL THE PARTS IN THE QUANTITIES MENTIONED BELOW. IF YOU ARE MISSING ANY PART, PLEASE STOP AND CONTACT US IMMEDIATELY ON: 1-800-CABINET OPTION 5

► **Items Quantity**

Item	Description	Qty
A	Face Frame	2
B	Face Panel	2
B-1	Left Side Panel	1
B-2	Right Side Panel	1
C	Bottom with turntable	1
E	Back Panel	1
F	Shelf with turntrble	1
G	Long Toe Kick (G) & Short Toe Kick (G-1)	2
J	Hardware box	1
	Plastic corner braces with screws 4pcs, Hinge with screws 4pcs	
M	Door	2

► **Required tools:**

- Screwdriver
- Adjustable wrench
- Measuring Tape
- Pencil
- Level
- Silicone

► **Instructions:**

1. **Assembling the Door Set:** put two doors set on a flat surface and align them from the screw marks.
2. Put face frame (A) face down on a flat soft working surface (**Figure 1**).

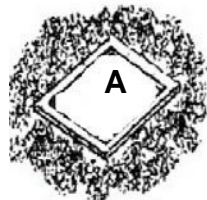

3. Insert left face panel (B) into the grooves of face frame (A) on the magnetic latch side. Align the plastic half part of the cam lock connectors. Make sure it fits and lock connectors with screwdriver by turning the screw located on the cam lock connector to the right 180° degrees (**see Figure 2**) Stand up side panel up right at this time.

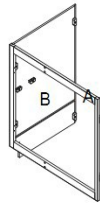

Figure 3

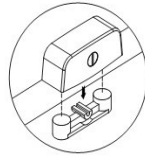

Figure 2

4. Insert the bottom (C) with turntable through face frame, well align the cam locks and lock the connectors

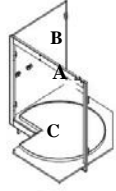

Figure 4

5. Insert right side panel (B-2) connect with the face frame (A) Align the cam lock connectors (Figure 5).

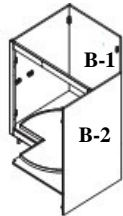

Figure 5

6. Place the back panel align the cam lock connectors with side panels. Make sure that it fits and is locked (Figure 6).

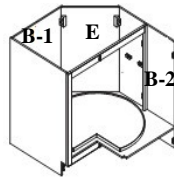

Figure 6

7. Insert shelf with turntable into position on short shelf steps, align the cam lock at bottom and tighten as shown in (Figure 7).

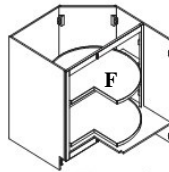

Figure 7

8. Place the face panel and align the cam lock connectors with side panels. Make sure that it fits and is locked. (Figure 8)



Figure 8

9. Place and mount door assembly (M) into two cam lock connectors on face frames first then into connectors on the right side panel. Make sure that all fit and lock the cam lock connectors on face frame first then into connectors on the right side panel. Screwing short toe kick (G) to long toe-kick (G-1) with cam lock, then put onto the cabinet under the door. Make sure that all fit and lock the cam lock connectors. Reposition the cabinet back to upright and cam lock bottom to the frame under the door.

10. **Installing the Corner Braces (Figures 9 and 10):** position and insert the 4 plastic corner braces in the locations shown in (Figures 9 and 10), secure them with 1/2" screws



Figure 9

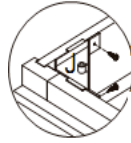

Figure 10

►Maintenance

For daily cleaning, use a dry cloth and a soft liquid cleaner.

Never use abrasive cleaners containing acetone, chlorine or strong bleach, nor tools as scrapers, metallic brushes, and other products which can scratch or tarnish surfaces.

Under no circumstances should you use chrome cleaner on chrome-plated or brass trim, hinges, handles, sockets etc.

Good ventilation is essential for maintaining the quality and look of this furniture.

► Limited 30 year warranty

This warranty applies to B.JORGSEN & CO.kitchen cabinets installed for residential use. B.JORGSEN & CO. warrants that, when installed in accordance with the installation instructions provided, the kitchen cabinets are free of manufacturing defects for a period of (30) thirty years from the date of purchase.

We guarantee your satisfaction with each kitchen cabinet. Should any kitchen cabinet not meet your satisfaction because of a visual defect, simply return it to your retailer, PRIOR to installation for a replacement. We are unable to correct any visual defects after installation is complete or after 21 days from the date of original delivery.

Information about your warranty coverage

This warranty does not cover damages or failure attributable to:

- Kitchen cabinets installed with obvious visual defects
- Defects or damage to kitchen cabinets caused by installation that does not comply strictly with the instructions provided with the kitchen cabinets.
- Issues related to the natural characteristics of wood products or the normal effects of aging
- Defects caused by product modifications completed by the owner/installer.
- Defects caused by exposure to the elements including moisture which may cause warping or splitting.
- Defects or damage to kitchen cabinets caused by severe accidents (e.g. fire, burns).
- Damage caused by flooding or standing water from leaking pipes, faucets, household appliances, etc: up to and including flooding and any damages caused by natural catastrophes.

Notes on Warranty:

- B.JORGSEN & CO. kitchen cabinets shall not be liable for either its failure to perform or its delays in performance hereunder arising out of or resulting from causes beyond its control, including but not limited to, acts of God, acts of Representatives, acts of Government, wars, fires, floods, epidemics, quarantine, strike, freight embargoes, weather or default by suppliers due to any such causes.
- This warranty applies only to the original purchaser and installation site and is not transferable.
- Wood characteristics naturally occurring such as variations in color, grain and knots are not considered defects.
- Color variations in cabinets are a natural occurrence due to wood species, age and exposure to UV light and sunlight and therefore such variations and changes are not considered defects.
- This warranty is valid only for residential installation

FOR WARRANTY SERVICE

To make a claim, contact CABINETS TO GO, acting as an agent for B.JORGSEN & CO., no later than 30 days following the date of discovery or detection of defect, at 1-8-66-8-39-2888 ext: 21. Proof of purchase, such as the bill of sale is mandatory when requesting warranty service.

CABINETS TO GO reserves the right to designate a representative to inspect the kitchen cabinet for analysis.

- No unauthorized person, installer, dealer, agent or employee of CABINETS TO GO or any other representative is entitled to assume any liability on behalf of CABINETS TO GO relating to the sale of this product or has the authority to increase or alter the obligations or limitations of this warranty.
- THE SOLE REMEDY PROVIDED BY THIS WARRANTY IS THE REPAIR OR REPLACEMENT OF ANY PART OR PARTS THAT MAY PROVE DEFFECTIVE UNDER NORMAL RESIDENTIAL USAGE. THIS WARRANTY DOES NOT COVER THE COST OF REMOVAL, INSTALLATION, DELAY OR TRANSPORTATION OF NEW PRODUCT.