

PD5000 Sliding/Pocket Door Locks



Sliding/Barn Door

Pocket Door

Specifications

Standard door thickness: 1-3/4" (45mm). Thick Door Kits available
 1-3/8" (35mm) door thickness: See FH27..SL option on page 14
 Backset: 2-3/4" (70mm), 2-1/2" (64mm), 2" (50mm)
 Handing: Non-Handed
 Thumbturn Spindle: 5x5mm square
 Deadbolt: 1" (25.4mm)
 Cylinder: Schlage C keyway 5 pin mortise cylinder with 2 keys (KD). Other keyways available upon request.
 Keying Services available. Order Separately.

Application

For residential or commercial application

Material

Lockcase: Heavy Gauge Steel
 Deadbolt and Edge Pull: Brass and Stainless Steel
 Faceplate and Strike: Stainless Steel or Brass
 Cylinder: Solid Brass

Trim

Please see pages 12-19 of catalog for Flush Pull design options. See pages 22-25 for Surface Pull design options. See page 21 for ADA compliance information

Finish

Locks and Surface Pulls for Sliding/Barn Doors: US32 (629) Bright Stainless Steel
 US32D (630) Satin Stainless Steel
 US19 (622) Flat Black

Lock and Flush Pulls for Pocket Doors:
 See pages 12-13 of catalog for all Finish options

Lock Options



PD50-234 (2-3/4" Backset)
 PD50-212 (2-1/2" Backset)
 PD50-200 (2" Backset)
 Edge Pull only



PD52-234 (2-3/4" Backset)
 PD52-212 (2-1/2" Backset)
 PD52-200 (2" Backset)
 Lockcase with built-in Dust Proof Strike for inactive pair of doors
 NO Edge Pull



PD53-234 (2-3/4" Backset)
 PD53-212 (2-1/2" Backset)
 PD53-200 (2" Backset)
 Lockcase with Deadbolt
 NO Edge Pull

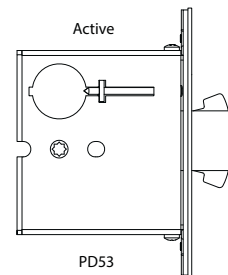

PD53

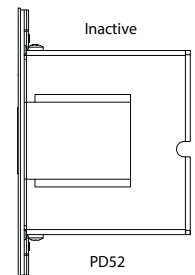

PD52

PD5000 Series Mortise Lock

PD53 : Lockcase with Deadbolt, NO Edge Pull

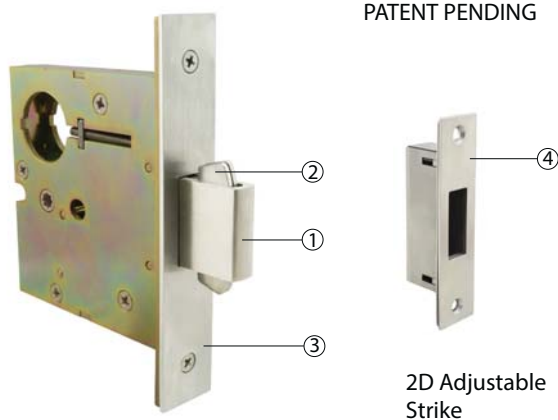

2D Adjustable Strike

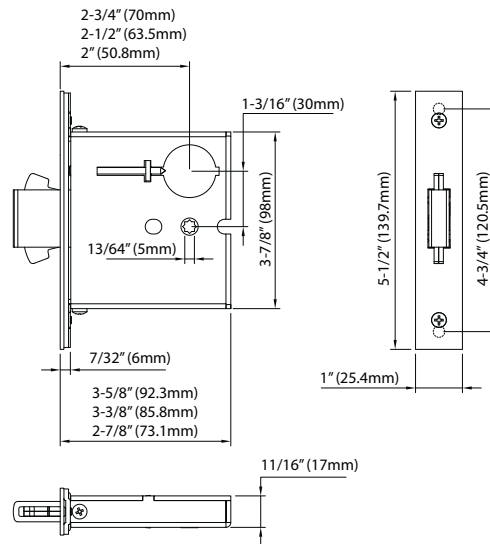

- 1) Brass deadbolt with 1" throw
- 2) Self-retracting hook with non-marring latch bolt
- 3) Stainless steel or brass faceplate, 2mm thick
- 4) Vertically-adjustable strike
2D Adjustable Strike optional (PD-ADJ-2D-STRK)
(2D Strike is shown)

Functions

Sliding/Barn Doors

	<p>PD5215 Passage w/Lockcase as Dust Proof Strike Lockcase used as dust proof strike on pair of doors inactive side.</p>		<p>PD5340 Privacy w/Emergency Release Deadbolt operated by inside Thumbturn or outside emergency release coin turn.</p>
	<p>BTB Dummy/Passage without Lock Case</p>		<p>PD5350 Entry w/Single Cylinder Key outside or Thumbturn inside retracts deadbolt.</p>
			<p>PD5360 Patio Deadbolt operated by Thumbturn from inside only.</p>

PD8000/PD5000 Mortise Locks with Surface Pulls for Sliding/Barn Doors

Americans with Disabilities Act (ADA) Compliance

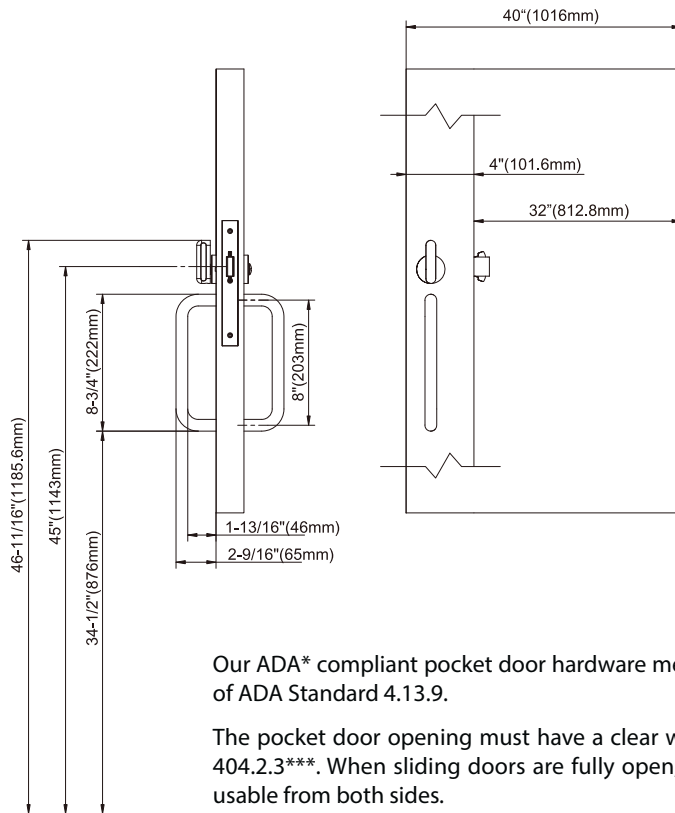

Our ADA* compliant pocket door hardware meets the "no grasp", "no pinch" requirements of ADA Standard 4.13.9.

The pocket door opening must have a clear width of 32" according to the ADA Standard 404.2.3***. When sliding doors are fully open, operating hardware shall be exposed and usable from both sides.

To accommodate these requirements, the total pocket door opening must be a MINIMUM of 40". The door must protrude a minimum of 4" from the jamb in order to install the ADA pocket door hardware on the door.

The hardware must be installed 34" above the finished floor or ground, giving the hardware a height of 47" (the maximum is 48") from the finished floor, meeting ADA Standard 404.2.7***.

* Americans with Disabilities Act

*** The ADA Standard 404.2.3 is from the Department of Justice ADA Publication dated September 15, 2012. Unison Hardware, Inc. recommends the end user double check all State and Federal standards for your particular project.

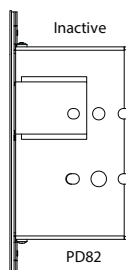
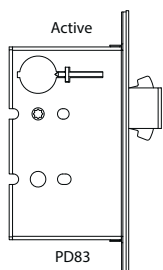

Mortise Cylinders and Keys

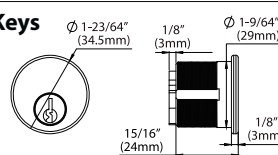

Schlage C keyway, 5 pin, with clover cam; includes 2 keys, standard Keyed Different (KD). Other keyways and other keying services available upon request. All keyed functions use 15/16" (24mm) mortise cylinder for standard 1-3/4" (44mm) door. Thick Door Kit available on request.

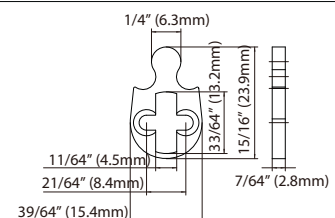

Clover Cam
CAM01-SCL

ADA* Pull Options

Material: Stainless Steel

Stock Finishes: US32D (630) Satin Stainless Steel
 US32 (629) Bright Stainless Steel
 SP (split 32/32D) - PHIX41714 only
 US19 (622) Flat Black

* Americans with Disabilities Act

PHIX31108

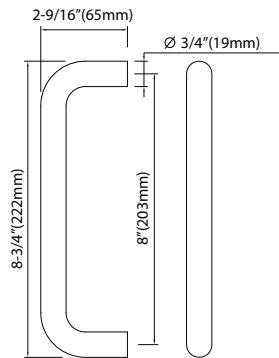

PHIX330.512.8

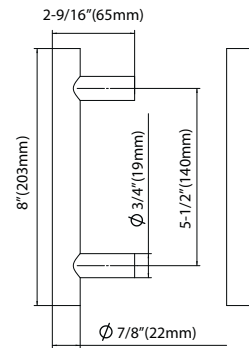

PHIX41714

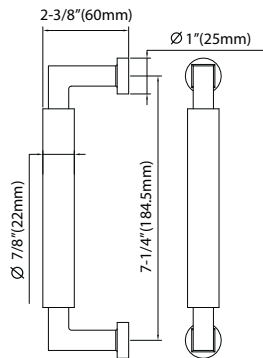

PHIX45714

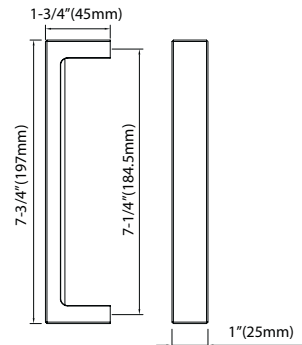

PHIX30108

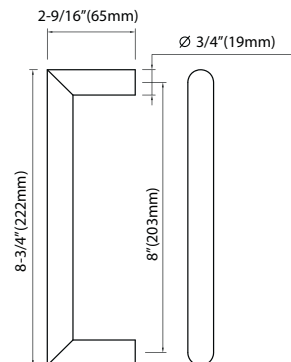

Cylinder Collar, Thumbturn and Release Options

GR02

GR Small Rose.
TT02 Thumb-turn and release



GR Rose
T-Turn Side



GR Rose
Release Side

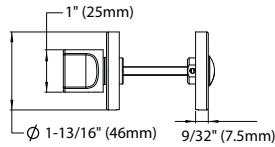

Product Illustration	Function	Item No.
	Mortise cylinder escutcheon	EC-R460COL
	Thumbturn on escutcheon	EC-R460TT02
	Thumbturn & Release	EC-R460TT02PVS

GR04

GR Small Rose.
TT04 Thumb-turn and release



GR Rose
T-Turn Side



GR Rose
Release Side

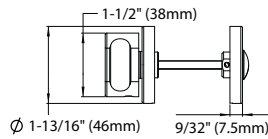

Product Illustration	Function	Item No.
	Mortise cylinder escutcheon	EC-R460COL
	Thumbturn on escutcheon	EC-R460TT04
	Thumbturn & Release	EC-R460TT04PVS

GR07

GR Small Rose.
TT04 Thumb-turn and release



GR Rose
T-Turn Side



GR Rose
Release Side

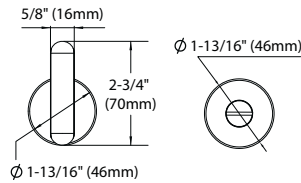

Product Illustration	Function	Item No.
	Mortise cylinder escutcheon	EC-R460COL
	Thumbturn on escutcheon	EC-R460TT07
	Thumbturn & Release	EC-R460TT07PVS

SR02

SR Small Rose.
TT04 Thumb-turn and release



SR Rose
T-Turn Side



SR Rose
Release Side

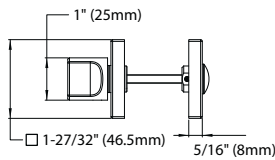

Product Illustration	Function	Item No.
	Mortise cylinder escutcheon	EC-S420COL
	Thumbturn on escutcheon	EC-S420TT02
	Thumbturn & Release	EC-S420TT02PVS

SR04

SR Small Rose.
TT04 Thumb-turn and release



SR Rose
T-Turn Side



SR Rose
Release Side

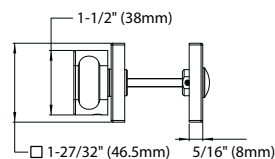

Product Illustration	Function	Item No.
	Mortise cylinder escutcheon	EC-S420COL
	Thumbturn on escutcheon	EC-S420TT04
	Thumbturn & Release	EC-S420TT04PVS