

FH23 Urban Flush Pull

For PD8000/PD5000 Sliding & Pocket Door Locks
Including FH23CF Concealed Fixing for 1-3/8" or Thicker Doors



FH23 w/PD84

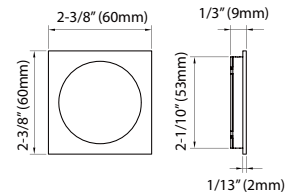
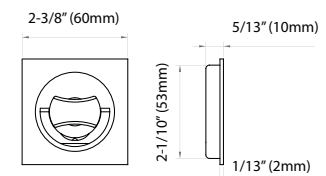

FH23 w/PD50

FH23CF (Concealed Fixing)
with PD84**FH23****FH23CF****Specifications**

Standard Door Thickness: 1-3/4" (45mm), Thick door kits available
1-3/8" Door Thickness: Use FH23CF
Handing: Non-Handed
Thumbturn Spindle: 5x5mm square
Deadbolt: 1" (25.4mm)
Cylinder: Schlage C keyway 5 pin mortise cylinder with 2 keys (KD)
Other keyways available upon request
Keying Services available. Order Separately

Application

For residential, hospitality or commercial application

Material

Stainless Steel/Brass

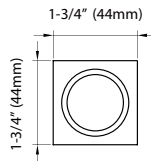
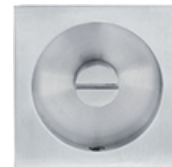
Trim Options and Finishes**Standard FH23 Urban Trim for doors 1-3/4"****FH2300**
Flush Pull Only**FH2303**
Flush Pull with
Cylinder Hole**FH2382**
Flush Pull with
TT08 Thumbturn**FH2304**
Flush Pull with
Thumbturn Release**Finish Options:**

- US3/605 Bright Brass
- US4/606 Satin Brass
- US10B/613 Oil Rubbed Bronze
- US14/618 Polished Nickel
- US15/619 Satin Nickel
- US26D/626 Satin Chrome
- US32/629 Bright Stainless Steel
- US32D/630 Satin Stainless Steel

FH23CF Urban trim for doors 1-3/8" thick or greater.

Only available for Passage, Privacy, and Patio (not Entry) functions

**FH2300CF**
Flush Pull Only**FH2362CF**
Flush Pull w/
TT06 Thumbturn**FH2304CF**
Flush Pull with
Thumbturn Release**Finish Options:**

- US4/606 Satin Brass
- US10B/613 Oil Rubbed Bronze
- 19G Graphite Black
- US26D/626 Satin Chrome
- US32/629 Bright Stainless Steel
- US32D/630 Satin Stainless Steel