

*The Art of Power*

# SLINGSHOT



2007 TURBO2 INSTRUCTION MANUAL

[WWW.SSKITEBOARDING.COM](http://WWW.SSKITEBOARDING.COM)

## WARNING

**DO NOT USE THIS SLINGSHOT PRODUCT UNLESS YOU HAVE READ AND UNDERSTAND THESE WARNINGS AND INSTRUCTIONS WHICH ARE FOR YOUR SAFETY AND PROTECTION. THIS INFORMATION MAY BE SUBJECT TO CHANGE AT ANYTIME. FOR CURRENT UPDATES, PLEASE VISIT OUR WEBSITE AT: [WWW.SSKITEBOARDING.COM](http://WWW.SSKITEBOARDING.COM)**

**IF YOU ARE UNDER THE AGE OF 18, YOU SHOULD HAVE YOUR PARENT OR GUARDIAN READ THESE WARNINGS AND INSTRUCTIONS AND SHOULD NOT USE THIS PRODUCT UNLESS YOU ARE UNDER THE PROPER GUIDANCE AND SUPERVISION OF SUCH A PERSON.**

The use of this product exposes the user to many unavoidable and unexpected risks, dangers and hazards. The suppliers of this product are not responsible for any damages to property or any personal injury caused by any use, misuse, abuse, or irresponsible use of this product.

Kiteboarding is an extreme sport. Power kites, their lines and control equipment can be dangerous to flyers and to anyone in the vicinity of their use. Kiteboarding must be taken seriously and we recommend that, **at least in the early stages of use**, you seek the guidance of professional instructors and experienced kiteboarders. Improper and/or unreasonable use of this kite may result in serious injury or death to yourself and others. Do not use your kite near power lines, airports or streets, and keep your kite flying lines away from people and obstacles. Always fly in an open area, observe wind and weather conditions, particularly in circumstances where you may encounter offshore, onshore winds or strong winds. Do not attempt to use your kite on water until you are confident and comfortable with the use of a trainer kite on land. Spend time to become familiar with the operation of your kite and remember that you are responsible for its operation and for safety of those around you. Do not attach yourself or tie yourself permanently to the kite lines. The kite is not intended for use as a flying device nor indeed is it intended as a means of flotation.



# TABLE OF CONTENTS

<b>Overview &amp; Package</b> .....	<b>4</b>
<b>Features &amp; Benefits</b> .....	<b>6</b>
<b>Safety</b> .....	<b>10</b>
<b>Kite Setup</b> .....	<b>20</b>
<b>Launching &amp; Landing</b> .....	<b>25</b>
<b>Performance</b> .....	<b>28</b>
<b>Tuning &amp; Maintenance</b> .....	<b>30</b>
<b>Frequently Asked Questions</b> .....	<b>34</b>
<b>Warranty / Disclaimer</b> .....	<b>36</b>

Slingshot an industry leader in innovation, quality and overall style constantly push the envelope to bring you, the rider, products that help you redefine your personal best.

## CONTACTS

If you require further assistance, please call, email or visit our website:  
[www.sskiteboarding.com](http://www.sskiteboarding.com)

**Rider Service Line (Toll free in the U.S.): 1-877-775-4832**  
**International Tel.: 509-427-4950**

## CUSTOMER SERVICE:

Domestic: [usa.service@sskiteboarding.com](mailto:usa.service@sskiteboarding.com)  
International: [intl.service@sskiteboarding.com](mailto:intl.service@sskiteboarding.com)

## **OVERVIEW**

The NEW 2007 Slingshot TURBO 2 is a 4 line bow style kite with its own proprietary DNA. The kite delivers all the rider requirements of range, instant de-power, boosting, re-launch ability and stability. The TURBO 2 is designed for any kiter, entry level to advanced, looking for 4 line simplicity in a bow style platform. Characteristics such as predictability, ease of use, unmatched range and overall performance make this the ideal all around kite. Along with a solid reputation and supported with Slingshot's commitment to unsurpassed customer service, the NEW Slingshot TURBO 2 makes kiteboarding accessible and fun!

### **KEY FEATURES**

- 4 Line simplicity
- NEW 4 Line Full Stroke Bar (Active Stopper Ball equipped)
- Slingshot's patented One pump
- Newly redesigned swept leading edge and canopy shape
- Wing tip scuff guards
- Neoprene seam guards (Industry first)
- NEW PREMIERE no stretch bridle system with 2 to 1 pulleys on the bar
- No Wear spectra pulley lines, and leader lines
- Yellow Power Ball

### **KEY PERFORMANCE ADVANCEMENTS COMPARED TO THE FIRST GENERATION TURBO DIESEL:**

- The most in flight stability available in a bow (no weird inverting)
- Ease of use
- Excellent water re-launch
- Excellent up wind performance
- More boost and hang time
- Faster turning
- Less bar pressure

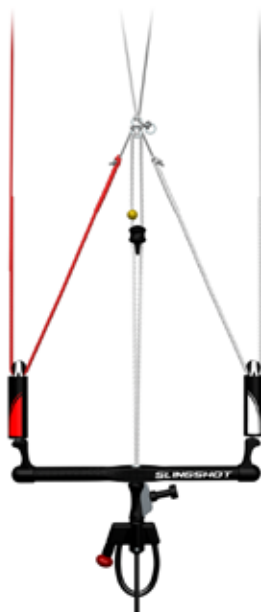

## PARTS LIST

1. TURBO 2 kite
2. 4 Line Full Stroke Bar (Active Stopper Ball equipped)
3. 23 meter line set
4. Newly redesigned kite backpack
5. Jenna J Double Pump
6. Patch Kit
7. User manual
8. Slingshot's commitment to unsurpassed customer service.

## 2007 TURBO2

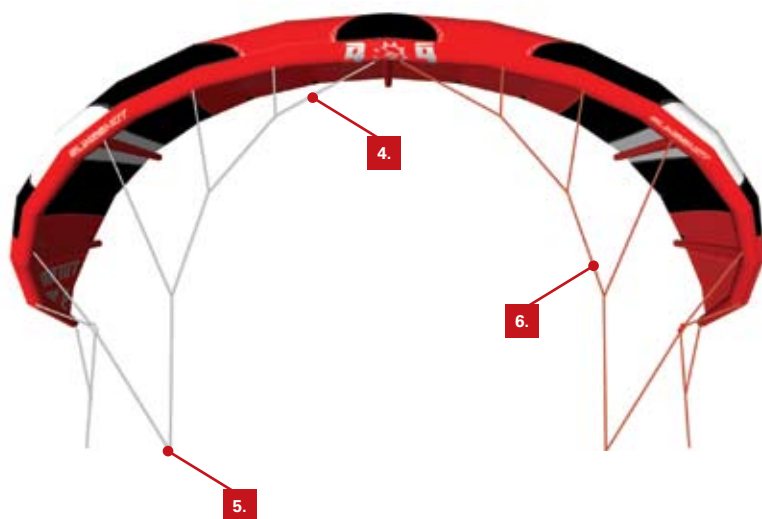
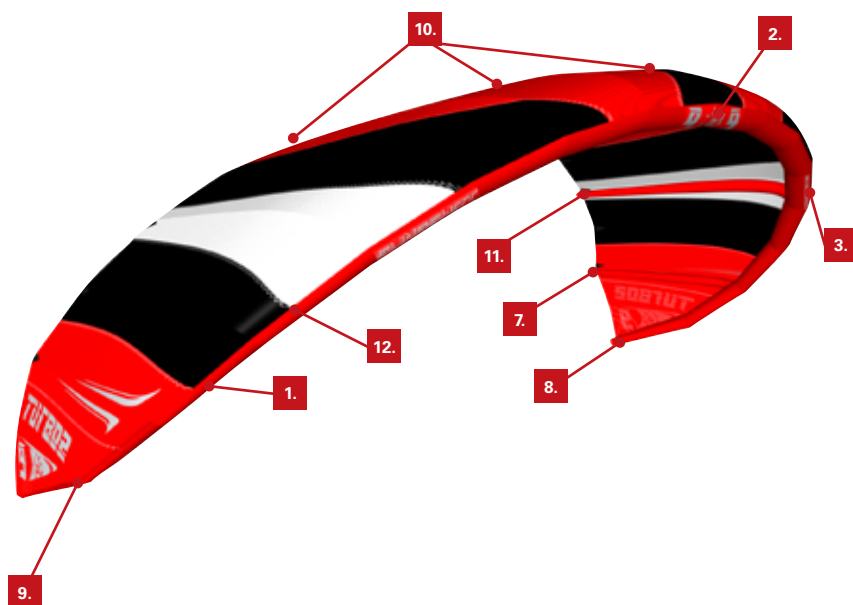



## FEATURES & BENEFITS

### 1. Continuous swept leading edge

- Effortless water re-launch.
- Enables the TURBO 2 to pivot more freely for better control and faster turning
- Enables more range and lighter bar pressure

### 2. Onepump

- The industry's original, proven and patented single point inflation system

### 3. NEW ergonomic Onepump nipple placement

- Less overall drag

### 4. Revolutionary NEW PREMIERE bridle material

- Dyneema bridle material tested to 900 lbs recognized to have the least amount of stretch. Bridle material maintains integrity. Guaranteed.

### 5. Loop to loop bridle attachment point

- Anti snag during re-launch

### 6. Simple floating bridle system

- Reduces bar pressure, hands off 100% de-power

### 7. Tailpipe bridle belts

- Keeps bridle from snagging on tail pipes

### 8. Self rescue handles

- Safely self rescue with webbed handles on the inside of each wingtip

### 9. Mark cloth scuff guards

- Prevents wear and tear while your kite is parked on the sand

### 10. Mark cloth LE/Canopy/Trailing edge reinforcement

- Increases durability and wear
- Helps to reduce flutter

### 11. Strut Tight Tail Pipes

- Easier bladder removal and installation

### 12. Reinforced Spectra bridle attachment points

- Durability where you need it.

### Legendary Slingshot construction

- The most durable kite construction on the market today

## 4 LINE FULL STROKE BAR

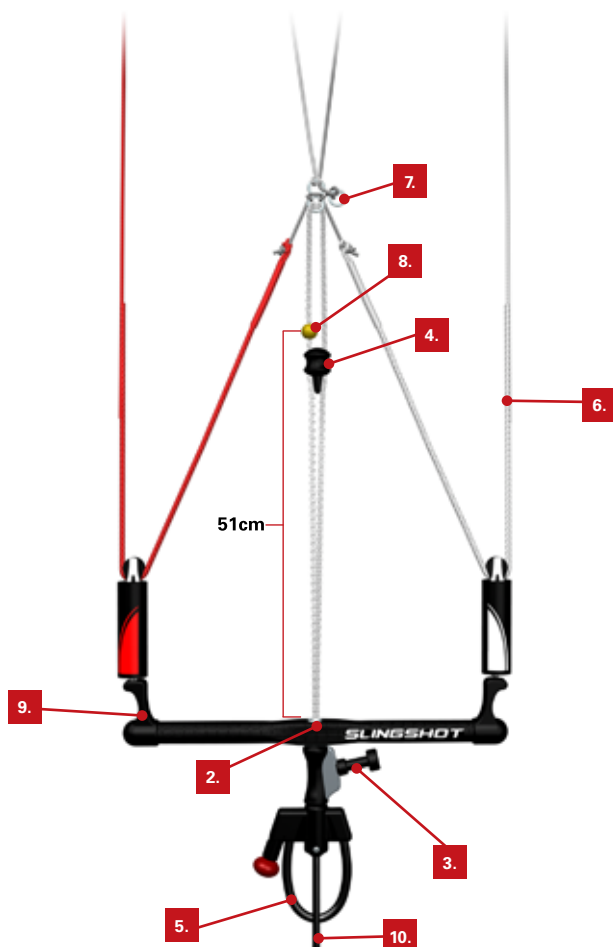

### POWERBALL SPECIFICATION

5m	51cm
7m	51cm
9m	51cm
11m	51cm
14m	51cm
17m	51cm





## FEATURES & BENEFITS

### 1. Newly redesigned 2007 4 Line Full Stroke Bar

- 100% de-power can be achieved simply by pushing the bar away from you and effectively sheeting out.

### 2. NEW Aluminium Power Steering Dug Out

- Reduces bar pressure/increases turning speed, prevents wear and tear on the chicken loop line and reduces weight

### 3. Below the bar de-power & TRIM

- Puts the convenience of front line power, de-power and TRIM within the reach of the rider.

### 4. Active Stopper Ball

- On-the-fly adjustment of chicken loop throw eliminates bar pressure associated with sheeting in for more power.

### 5. Lock-N-Load Chicken Loop

- Safe and immediate no load release in any situation.

### 6. Super grip leader lines

- Easy to grab lines eliminate the discomfort on hands and reduces potential tangles when relaunching.

### 7. Center flying line safety system

- Full de-power when engaged.

### 8. Yellow Power Ball

- Chicken throw limiter established maximum chicken loop throw

### 9. Line winders

- Keeps all of your kite line secure when not in use.

### 10. Removable Donkey Dick

- Easy on/off donkey dick for convenience and security.

## **SAFETY**

### **IMPORTANT INFORMATION**

**FOR THE SAFETY OF YOU AND THOSE AROUND YOU, PLEASE READ THE FOLLOWING SAFETY REMINDERS BEFORE OPERATING YOUR SLINGSHOT KITE.**

- The use of this equipment could result in risk of serious bodily injury or death to yourself or those in close proximity to you.
- Slingshot strongly recommends that beginners take a lesson from a certified school.
- This product is designed and manufactured for recreational use on water or snow only.
- Slingshot advises that you closely inspect your equipment for signs of wear and tear before each use. If there are any signs of wear and tear, replace or repair them immediately. Contact [www.sskiteboarding.com](http://www.sskiteboarding.com) for more information.
- Never put yourself in a situation where breakage of any of the components would put you or anyone else in danger.
- Although these kites have a huge wind range, flying this kite in over powered condition can be dangerous and is not recommended.
- Slingshot strongly recommends using appropriate protective gear including a certified helmet, flotation devise, and wetsuit in cool water.
- Make sure you use properly designed and manufactured parts from reputable suppliers. (Harnesses, helmets, etc)
- Study the current conditions including, waves, tides, currents, and weather forecasts before going kiteboarding.
- Become familiar with any new kiteboarding location by talking to the locals and asking questions. Study the weather conditions and know your launching and landing zones.



- **Watch out for other beach users including sunbathers, fisherman, sand castle builders and volleyball players and remember they have the right of way.**
- **Be sure you have your kite, board, and lines under control at all times.**
- **Use the buddy system by riding with a buddy. Before kiteboarding, always let someone know where you will be riding and when you plan to return.**
- **Keep your eye on the constantly changing conditions. Always return to the beach if there is a significant change in the weather. (Waves increasing, gusty winds, wind dying etc.)**
- **As you learn the sport, work within your own limitations and do not exceed them.**
- **Do not alter or modify any Slingshot products.**
- **Slingshot has designed this kite for kiteboarders averaging 175 pounds. The minimum weight of a rider using this kite is 105 pounds. The maximum weight is 220 pounds.**
- **Refer to these instructions for future reference.**

## SAFETY

### INSTANT DE-POWER

The design of the kite combined with our revolutionary bar has made this kite the ultimate in on-demand de-power. Immediate de-power is accomplished by pushing the bar away from you. It's that simple. The rider has total control of how much power the kite generates by sheeting in or out on the center line chicken rope. Sheeted all the way in is full power. As you sheet out, the power decreases until you reach the point of total de-power and the kite will reach its maximum depower capability for the given wind speed. Note that it is not recommended that you fly your kite outside the maximum wind range. Although the TURBO 2 is equipped with immediate de-power if flown beyond its comfort zone it will always retain some power. We recommend that you fly the right size kite for the right wind range for ultimate safety.

### HOW THE KITE'S POWER IS AFFECTED BY THE BAR:

**Sheeted in:** The kite has more power.

**Sheeted out:** The kite has less power.

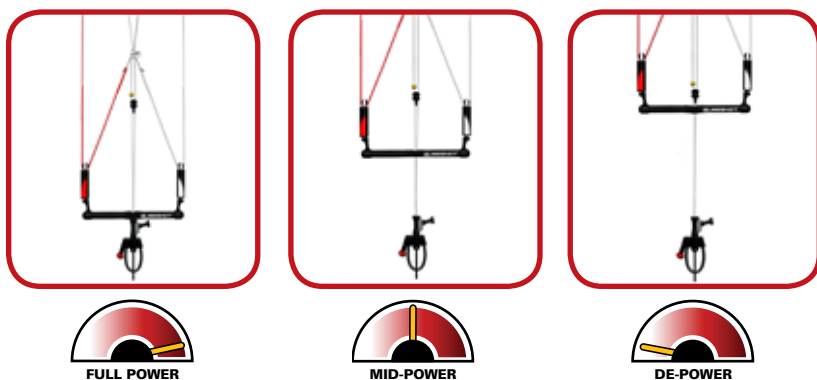

100% de-power can be achieved simply by pushing the bar away from you an effectively sheeting out. For riders that want to further fine tune their bar position and pressure the de-power strap located below the bar should be used. The kite's power meter is shown below each image. Red, sheeted in means that the kite has the most power. White, sheeted out means that the kite has the least amount of power. Important Note: The Active Stopper Ball will limit depower of the kite. To ensure 100% depower, make sure the Active Stopper Ball is placed away from you against the Yellow Power Ball.

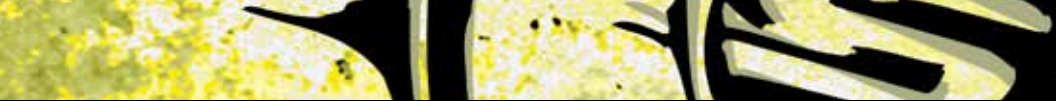

## **RELEASE SYSTEM**

If you find yourself in a situation where you need to separate from the kite, eject from your chicken loop by pulling the red safety release knob on your Lock-N-Load chicken loop. This will activate 100% de-power by flagging the kite allowing it to fall gently from the sky. If for some reason you still need complete separation, you can activate the quick release on our Quick Release Surefire Bungee leash.

## **REDUNDANT SAFETY**

The design of this kite and bar system gives the rider multiple options for safety. The rider has the ability to be hooked in and let go of the bar for instant de-power as long as the Active Stopper Ball is pushed away and touches the yellow Power Ball. If the Active Stopper Ball is pulled in, the rider can pull the Lock-n-Load safety system which releases the rider from the bar and activates instant de-power. If the leash is attached to the O-Shit ring on the front flying lines, the kite will flag and fall directly downwind till the kite rests safely on the water. The rider will remain attached to the kite with the Quick Release Surefire Bungee leash. If the rider chooses to completely separate from the bar and the kite, simply pull the red handle on the Quick Release Surefire Bungee leash.

## SAFETY

### UNHOOK AND LET GO:

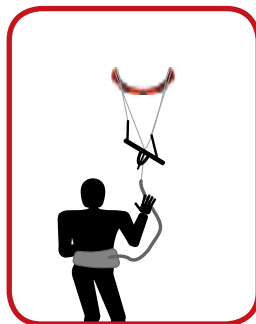

### RELEASING LOCK-N-LOAD SAFETY SYSTEM

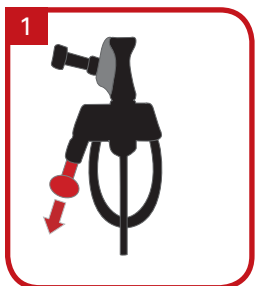

#### STEP 1

Firmly grasp the red safety release knob and pull away from the direction of the bar.

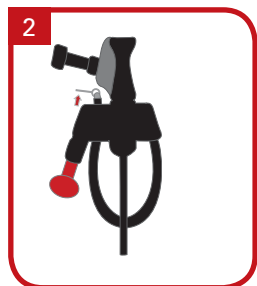

#### STEP 2

Continue to hold the red safety release knob until the safety pin is released.

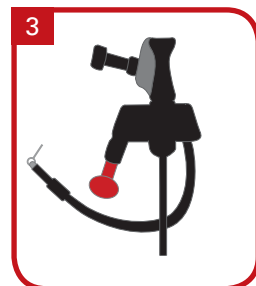

#### STEP 3

The Lock-N-Load harness line will then disconnect and free the harness spreader bar and rider from the Lock-N-Load safety system.

## REBOOTING LOCK-N-LOAD SAFETY SYSTEM

### STEP 1

Feed the safety pin through the opening next to the safety release knob.

### STEP 2

Continue to insert the pin into the Lock-N-Load hole until the harness line is seated in the hole

### STEP 3

Fold safety pin over and pull back the safety release knob at the same time.

### STEP 4

Feed the safety pin into the opening at the end of the safety release knob and release the knob.

### STEP 5

Pull on the chicken loop to assure a proper reboot.

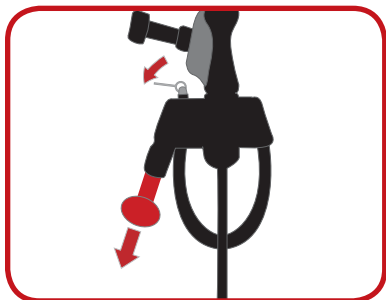
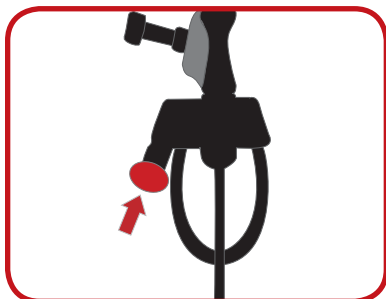
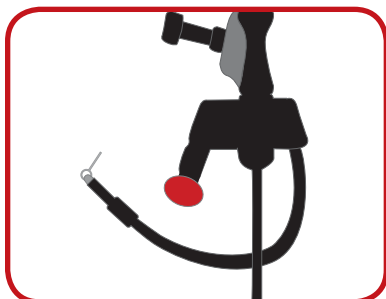

## SAFETY

### SUREFIRE BUNGEE LEASH ATTACHMENT

#### STEP 1

Make sure the end of the Quick Release Surefire Bungee Leash, with the red release handle closest to the rider, is attached to a metal ring or secure place on your harness using the stainless steel clip.

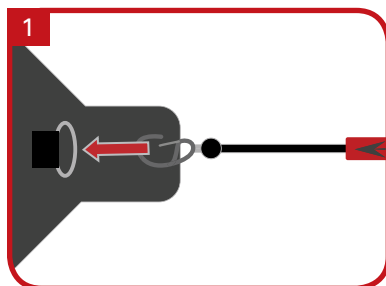

#### STEP 2

The other stainless steel clip attaches the O-Shit ring located on the center flying lines.





## SUREFIRE BUNGEE LEASH ACTIVATION

To completely disconnect yourself from the kite, firmly grasp the red safety handle on the Quick Release Surefire Bungee and pull towards you in the same direction the arrow indicates.

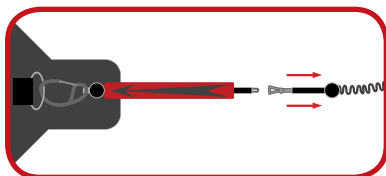
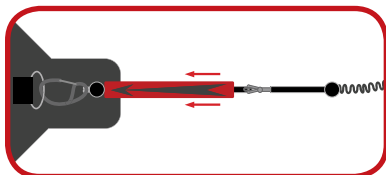
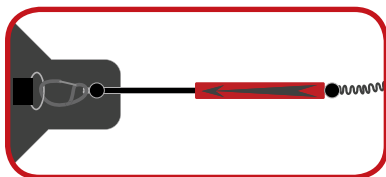

## SAFETY

### REBOOTING THE SUREFIRE BUNGEE LEASH

There are two sections of the Quick Release Surefire Bungee leash that, when connected, make a complete Quick Release Surefire Bungee leash. One end of the leash has the red safety handle with a stainless steel ring and the other end has an Amsteel loop.

#### STEP 1

Insert the front half of stainless steel oval ring in the Amsteel loop.

#### STEP 2

Fold the oval stainless steel ring over the Amsteel loop and secure the end of the stainless steel oval ring into the plastic tubing of the red safety handle.

#### STEP 3

Grasp the red safety handle and pull it over the stainless steel oval ring and continue to pull down until it rest securely against the round plastic ball.

#### STEP 4

Double check that your surefire bungee leash is seated properly by pulling to the outside of the red handle on both sides.

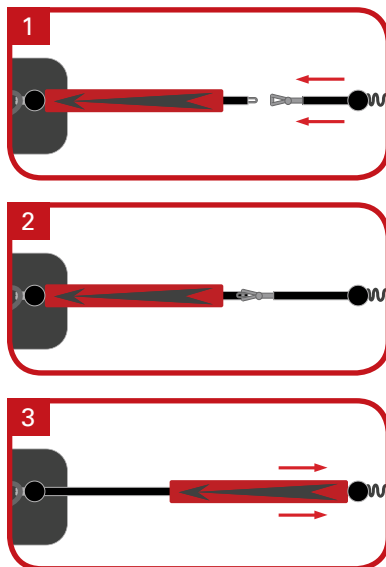

## WIND RANGE

The TURBO 2 kite naturally has more range than a traditional 'C' shape kite. Having said this we still recommend the three kite quiver to ensure maximum enjoyment of the sport while maintaining safety.

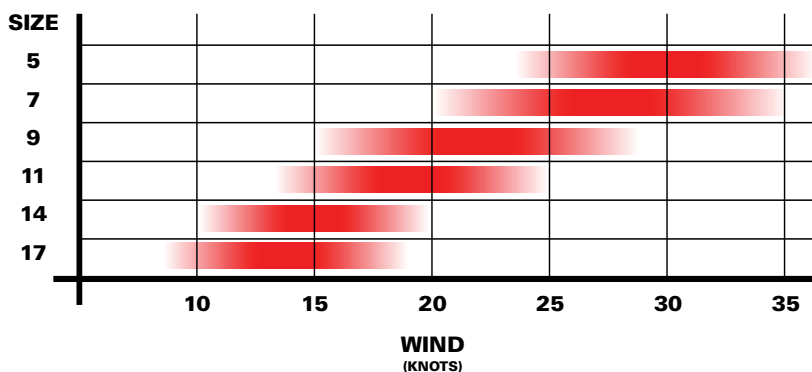

## TURBO 2 SIZING

5m	23-35+ mph
7m	20-35 mph
9m	15-28 mph
11m	13-25 mph
14m	10-20 mph
17m	8-18 mph

## IMPORTANT NOTE:

The graph above shows the recommended wind range for the TURBO DIESEL II. Actual wind ranges vary due to body weight, board size, water conditions, ability level and riding style. Due to the de-power characteristics of the TURBO 2 it can be flown outside of the range noted but is not endorsed by Slingshot. Regardless of your height, weight or skill level, Slingshot encourages you to adhere to all safety notes in this user manual. No kite is 100% safe. Flying any kite outside of it's intended wind range is dangerous.

## KITE SET-UP

### INFLATION

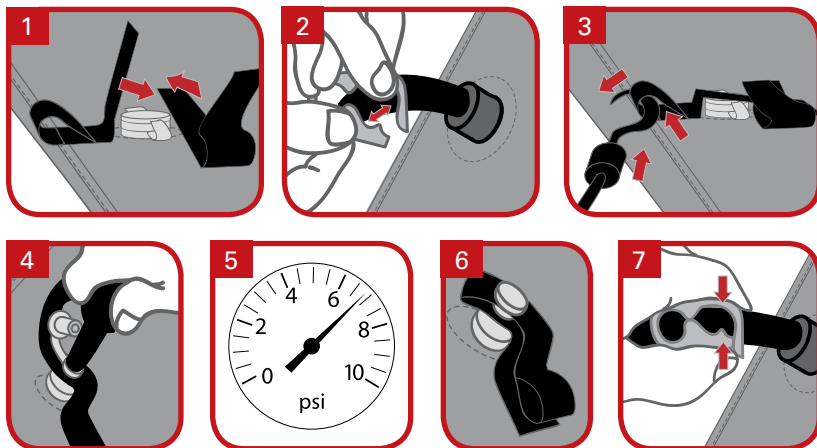

#### STEP 1

Close the OUT valve and secure with Velcro straps.

#### STEP 2

Make sure the valve clips for the struts are open.

#### STEP 3

Clip the pump leash to the leash loop on the leading edge (LE) of the kite.

#### STEP 4

Insert pump nozzle into the IN valve and secure with a slight twist.

#### STEP 5

Inflate kite to 8 psi. In constant air temperatures above 85 ° F / 30° C, inflate only to 6 psi. This is due to air expansion in higher temperatures

#### STEP 6

Pull pump nozzle and secure valve with Velcro straps. No pinching is required.

#### STEP 7

Clip all valve clips to lock air for each strut. This will allow your struts to remain inflated in the event that your LE loses air.

## CHECKING YOUR LINE LENGTHS

All 2007 Slingshot bars come with the flying lines attached to the bar and ready to fly. However, it is good practice to check your line lengths every ten sessions. **Note** - For an accurate line length measurement, release the de-power handle all the way out for 100% even line lengths.

### STEP 1

Walk out your lines and separate them so there are no twists.

### STEP 2

Wrap your Quick Release Surefire Bungee leash around a pole, fence post, or tree and use one stainless steel clip and clip it to the ring at the bottom to the other clip.

### STEP 3

Loosen your kook proof pigtails and thread the loops at the end of your flying lines over the clip on the outer stainless steel clip.

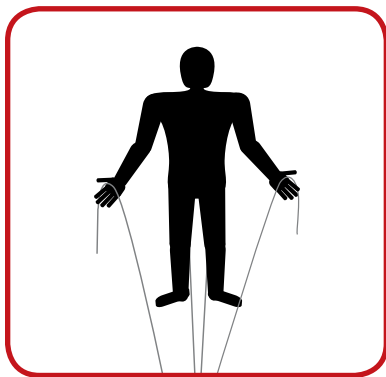

### STEP 4

Walk back to your bar and pull tight. If all line lengths are even and correct, the four lines will be equally taut.

### STEP 5

The top of the Lock-N-Load should be butted up firmly against the bar.

**NOTE** - If there is any difference in length between your front lines and rear lines, try adjusting your de-power strap to accommodate for the difference.

## KITE SET-UP

### LARK'S HEAD KNOT

#### STEP 1

Shape the loop at the end of your flying line so it is round and fold the loop over onto itself at the point where the stitching ends next to the loop.

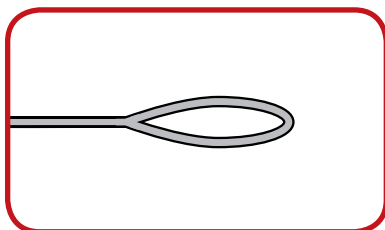

#### STEP 2

Push the sewn portion of the flying line through the round loop.

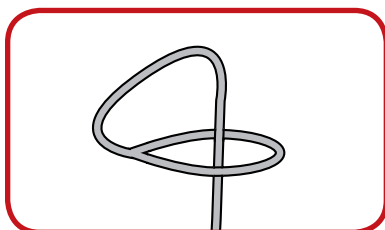

#### STEP 3

The end of your line should look like this. You may need to untwist the loop slightly to get it to look as shown in this picture.

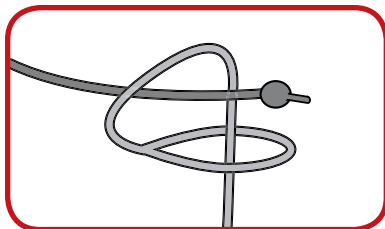

#### STEP 4

Slide the knotted end of the line that you are connecting to through the opening of the lark's head you just formed. Cinch down the larks hard and pull it up tight against the knot on the other line. Pull both lines away from one another to make sure the knot is properly secured.

## VISUAL BRIDLE CHECK

Before attaching your flying lines to your bridle do a simple visual bridle check. Grab the rear line connection point of the bridle and stretch it back until it is taught. Make sure there are no twists in the lines or bridle parts contacting the bridle. Now grab the front line connection point of the bridle and stretch it back to assure there are no tangles in the bridle (untangle the bridle if necessary). Once you are confident the bridle lines are free of tangles, hold both line connection points in separate hands for one last visual check. If there are no tangles you are ready to attach the flying lines.

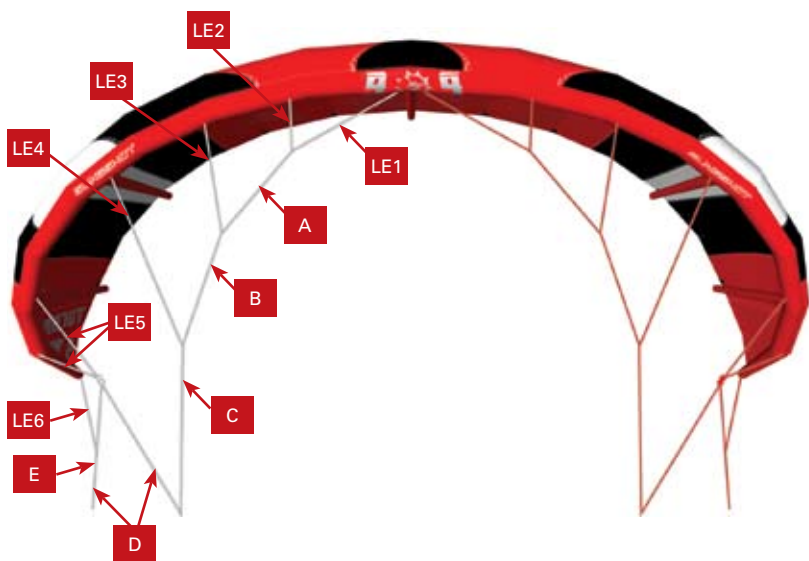

## ATTACHING LINES TO KITE

### STEP 1

Remove your kite from the bag and unroll it with the struts and intake valve facing upwards. See page 19 for information on inflation.

### STEP 2

Flip the kite over with the leading edge facing the wind and secure it by putting a sand bag, or piling some sand or snow on the kite's canopy.

## KITE SET-UP



### STEP 3

Lay out the bar and lines upwind of the kite. Make sure the white side (Slingshot logo) of the bar is facing upwards. The red side of the bar should be on your left. Walk out and separate your lines twice to assure they are not crossed. Lay your steering lines a slightly wider distance than the width of your kite. Lay out your flying lines in between the steering lines.

### STEP 4

Lay your kite with leading edge facing the bar, on top of the center lines with the outside lines laying to the outside of the kite, 1 meter from the end of the lines. Place sand, snow or a sand bag on the leading edge of the kite to secure it.

### STEP 5

Locate one side of the bridle and pull it out from the rear of the kite. Make sure there are no tangles by doing a visual



bridle check (see page 22), and separate the front (leading edge) bridle from the back (trailing edge) bridle and lay them out on the beach.

### STEP 6

Attach the white (right side) outside steering line to the white trailing edge pigtail of the bridle. Next attach the red (left side) outside steering line to the red trailing edge pigtail of the bridle.

### STEP 7

Next, attach the right side grey flying line to the grey leading edge bridle and do the same for the left side grey flying line and grey leading edge bridle.



## LAUNCHING & LANDING

Just before launching your kite, have a friend hold your kite in the launch position at the side of the wind window and do a visual check to make sure you have no tangles in your lines or bridle and they are attached correctly to your kite.



### STEP 1

Find an open area with unobstructed steady wind. Make sure there aren't any rocks, trees, fences, cars, power lines or people downwind of you or in your wind window.

### STEP 2

Have your launching partner walk your kite to the edge of the wind window and have them turn the kite on its side and hold the leading edge facing towards the wind.

### STEP 3

Make sure your Active Stopper Ball is pushed out for maximum de-power.



### STEP 4 + 5

Signal to your launching partner that you're ready to launch, and as they let go of your kite, pull the top half of your bar towards you to slowly raise your kite into the sky to the neutral position.

### STEP 6

Get in the water quickly and enjoy your session! **NOTE** - If there is any sand or grit on your bar or chicken loop line. Submerge the bar in the water to cleanse the product for a properly working system. This will increase the overall life of your bar, chicken loop rope and cleat.

## LAUNCHING & LANDING

### RELAUNCHING ON WATER

#### STEP 1

To perform a controlled relaunch, push the Active Stopper Ball away from you until it meets the yellow stopper ball and determine in which direction you want your kite to launch.

#### STEP 2

If you want the kite to launch to your left, pull in the right side of the bar and grab the right trailing edge leader line and pull toward you. You may have to pull the entire leader line to make the kite roll up on its wing tip. If you decide to launch the kite to the right, perform the procedure on the left side of the bar.

#### STEP 3

As the kite rolls over onto its wingtip expect to let a little bit of leader line out to keep the kite balanced on its wingtip. Continue to hold the leader line and move the kite to the edge of the window. As you work the kite to the edge, sheet out for a controlled relaunch.

#### STEP 4

When the kite is ready to launch, slowly release the outside leader line and place both hands back on the bar. Once airborne, steer the kite to the neutral overhead position and prepare to ride.

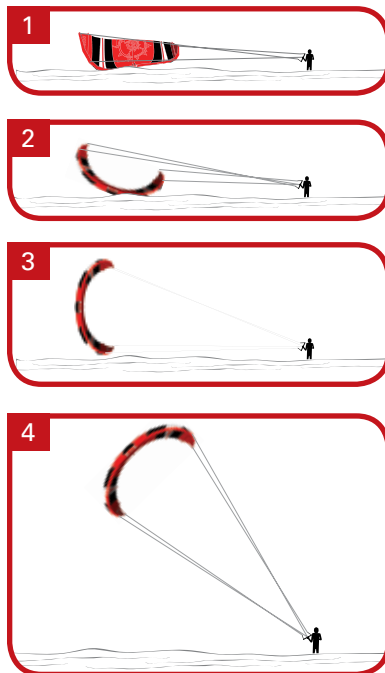

**RELAUNCH TIP:** If the kite lands leading edge toward you, pull as much outside line as you can on one side until the kite starts to turn around. Once the kite starts to rotate, start pulling on the opposite outside line to complete the rotation. This is a bit tricky and will take some practice to accomplish. Don't be afraid to be fairly aggressive with your leader lines. When the kite is directly downwind and on its leading edge, follow the standard water relaunch sequence. **Note:** When handling flying lines, make sure not to tangle the line around any body parts or equipment.

## LANDING THE TURBO 2 WITH A FRIEND

### STEP 1

Tap the top of your head and confirm with the person helping you that they are ready to catch your kite.

### STEP 2

With ample free space, fly your kite to the edge of the window and begin to land your kite slowly towards the person helping in landing your kite.



### STEP 3

Once your friend grabs your TURBO 2 by the leading edge begin to walk toward them to release flying line tension.

### STEP 4

Once safely landed place your kite leading edge downwards facing the wind and start de-rigging.



## PERFORMANCE

### ACTIVE ADJUSTABLE STOPPER BALL USE

Always launch and relaunch your kite with your Active Stopper Ball pushed all the way out for maximum safety. Once your kite is up then readjust according to your preference in the current conditions.

If your Active Stopper Ball is pulled in and you want to push it out and de-power at the same time, grip the bar next to the chicken loop rope and place your two pointer fingers around the bar and the Active Stopper Ball. Your fingers will keep the Active Stopper Ball from pinching the chicken loop rope and allow you to move the stopper up freely while sheeting out.

In light wind, pull in your Active Stopper Ball close to the bar until your kite is trimmed for the current conditions to reduce bar pressure.

### DE-POWER ADJUSTMENT BELOW THE BAR

The TURBO 2 de-power cleat and handle is located within reach of every rider. We have designed the chicken loop system and brought our adjustment cleat and handle below the bar and mounted it onto the chicken loop.

From this new location, you can easily adjust the throw depending on the conditions you are riding. In a situation when you are overpowered in stronger wind, or if the kite is stalling in lighter wind, you may need to pull in your de-power handle accordingly. Pulling in your de-power handle also brings the bar pressure closer to you.

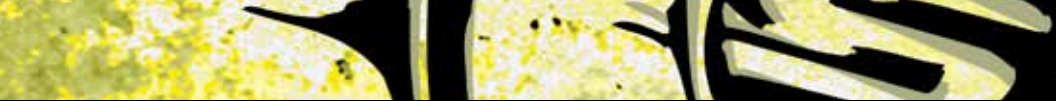

## **SHEETING**

Sheeting the TURBO 2 is as simple as hooking in to the chicken loop and pushing the bar away from you to sheet out and pulling the bar towards you to sheet in. Sheeting the kite in offers the rider maximum power and the quickest response when turning. Sheeting out allows the rider to adjust the amount of power to total de-power. Fine tuning the amount of power can be advantageous in gusty conditions or when feeling over powered.

## **DE-POWER HANDLE**

The de-power handle found on the chicken loop rope below the bar allows the rider to reduce the amount of power in the kite. By pulling the handle down and locking the chicken loop rope off, the amount of power can be fine tuned and brings the desired amount of bar pressure and throw closer to the rider.

## **RIDING UNHOOKED**

Riding unhooked offers the rider a constant amount of power and frees the body for dynamic moves like a handle pass or an air railey. To tune the TURBO 2 for unhooked riding, simply unhook and make sure your kite has the power you desire. If your kite is stalling backwards, pull in the de-power strap a few inches or until the power feels right for the current conditions.

## TUNING AND MAINTENANCE

### BLADDER MAINTENANCE (REMOVAL)

#### STEP 1

First, pull off the strut hose by rolling back the tubing from the nipple of the bad strut.

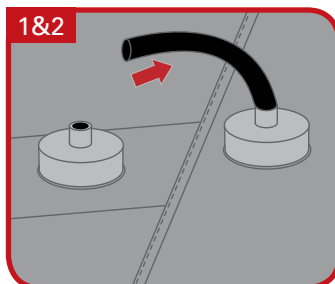

#### STEP 2

Tie a string, longer than the length of the bladder, to the valve.

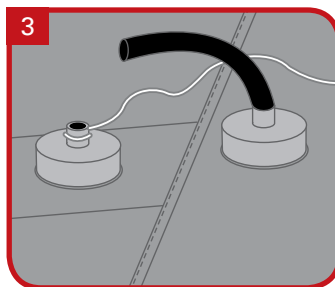

#### STEP 3

Open the strut from the tailpipe end and slowly pull the bladder out, making sure you do not pull the string through the bladder on the other end.

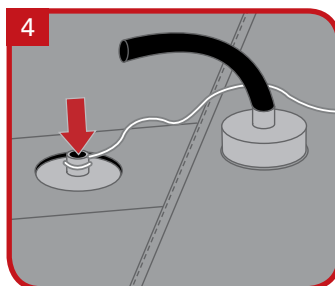

#### STEP 4

Untie string from bad bladder and re-attach to new bladder.

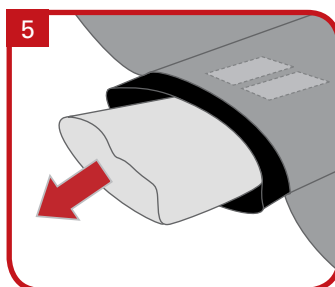

## BLADDER MAINTENANCE (INSTALLATION)

### STEP 1

Pull new bladder through strut tail pipe, with string towards LE end of strut.

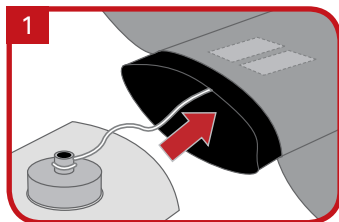

### STEP 2

Reseat the bladder valve into opening by pulling valve through until flange sits on top of the strut.

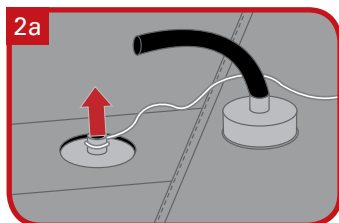

### STEP 3

Reseal the tailpipe by folding and tucking bladder casing into the strut. Seal tailpipe with the Velcro closure.

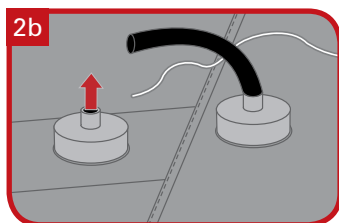

### STEP 4

To reseal the strut hose to the nipple, dip the hose in soapy water and slide back onto the nipple. Let dry 10 minutes before use.

### STEP 5

Inflate strut with 2 PSI making sure the bladder fills the strut. This may take a little massaging. This is very important.

Tip: Make sure to rotate all isolation clips (sharp edges) away from the canopy side of the kite.

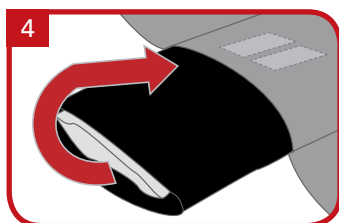
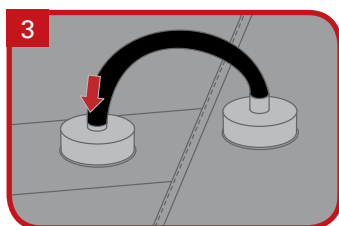

## TUNING AND MAINTENANCE

### PACKING



#### STEP 1

Lay out your kite leading edge facing up and fold all bridle lines to the inside of the kite.

#### STEP 2

Fold kite in half lengthwise at the ends.

#### STEP 3

Make 1 foot wide flat folds from the wing tip to the center strut and repeat steps on the other side.

#### STEP 4

Stuff your freshly folded kite into your new kite backpack.





## FREQUENTLY ASKED QUESTIONS

### **What factors contribute towards the TURBO 2 overall price?**

Slingshot's primary goal is to provide overall value to the customer. What this means is selling a superior quality kite backed by unmatched customer experience at the best possible price. When you buy a Slingshot kite you not only buy a technologically superior product but you also inherit the entire Slingshot customer service family.

Slingshot kites have been and always will be known for their legendary bomber construction. We recognize that kites take a fair amount of abuse from being crashed onto the water, land and even some undesirable objects such as bushes and rocks. We also recognize the need for your gear to withstand the daily abuse of relentless wind and sun. This is the reason behind Slingshot's decision to place such an emphasis on quality and durability.

Slingshot is also synonymous with innovation. Innovations such as our patented Onepump single point inflation technology, the revolutionary 4 Line Full Stroke Bar, below the bar TRIM / de-power and the Active Stopper Ball are just to name a few. We constantly push and test the technology envelope to bring you, the rider; quality products that help you set a new personal best.

Our experienced newly established Rider Service Hotline is always available and eager to help via phone or email. If you have any questions or concerns, just contact us, and you will receive a professional and timely response. Great customer service is our number one.

### **What does the 4 line bridle do?**

The bridle is necessary to support the flatter shape of the TURBO 2 kite. This bow style shape allows for more range and de-power given an increased projected area resulting in a more efficient kite.

### **Why does the new 4 Line Full Stroke Bar have bar mounted pulleys?**

The 4 Line Full Stroke Bar, simply put, is the cleanest most versatile bar on the market. Bar mounted pulleys are necessary to achieve full depower associated with these flatter style kites. 4 line Full Stroke Bar has bar mounted pulleys to allow for a 2 to 1 ratio on the steering lines and sheeting.



### **How does the new 2007 Slingshot TURBO 2 line deal with the topic of inversion?**

The reason why inversion is a typical characteristic of these flatter style kites is because of the response associated with 100% de-power. In its second generation, the new TURBO 2 has answered the problem of inversion with refined, well balanced kite unique to Slingshot. In addition the NEW bridle configuration and NEW swept leading edge technology prevent the kite from falling out of the sky when fully depowered.

Chief designer Tony Logosz and the entire Slingshot R&D team have created this proprietary canopy shape of the TURBO 2 and design of the 4 Line Full Stroke Bar with Active Stopper Ball make inversion a thing of the past.

### **Is the 4 Line Full Stroke Bar compatible with my other kites and can I use other bars on my TURBO 2 kite?**

The 4 Line Full Stroke Bar is only recommended for use with the TURBO 2 kite due to the nature of the de-power feature on this kite. To ensure maximum performance and safety benefits, always use the 4 Line Full Stroke Bar and the TURBO 2 kite together.

### **How hard should I pump my TURBO DIESEL II?**

Average is 8 PSI. Also make sure all of your clips to the one pump are closed so that your struts stay firm.

### **Where do I go for a TURBO 2 knowledge base?**

Call our Rider Service Hotline at 877-775-4832 (toll free in the US) / 509-427-4950 (international) or email us at [tech@sskiteboarding.com](mailto:tech@sskiteboarding.com).

## **WARRANTY**

## GUIDELINES

**General Warranty Policy applying to customers located within U.S. If a product is found defective by Slingshot, in its sole discretion, Slingshot's only responsibility shall be limited to credit, repair or replacement of the defective product. Slingshot will not be responsible for any costs, losses or damages incurred as a result of loss or use of product.**

**This warranty is subject to the following limitations:**

1. Slingshot warrants all products, with some exceptions, sold by Slingshot to be free of defects in material or workmanship for a period of 90 days from the date of purchase.
2. The warranty applies only to Slingshot products purchased from Authorized Slingshot Dealers and is valid for the original purchaser only.
3. All products returned to Slingshot for warranty inspection must receive a return authorization which can be given over the phone or via email from our warranty department: Inside the USA tel: 877-775-4843, international tel: 509-427-4950 or by email at: [warranty@sskiteboarding.com](mailto:warranty@sskiteboarding.com)
4. The customer is responsible for the cost of shipping products freight prepaid and insured. Slingshot assumes no responsibility for products during shipment from the customer to our Warranty Department. Shipping charges are non-refundable.

5. Slingshot assumes responsibility for return shipping and insurance costs to the customer.

6. All coverage under this warranty is void if any modification, change or alteration has been made to the product that is not specifically authorized in writing by Slingshot.

7. Repaired or replaced products are covered for the remainder of the original warranty only.

8. All warranty claims must be accompanied by the original purchase receipt from an Authorized Slingshot Dealer. Invoice or charge receipt must clearly identify the dealer, date of purchase and the item

## STEP ONE

Evaluating the validity of the claim.

Before you submit a warranty claim...be sure that you can answer "yes" to all of these questions below.

- Was the product purchased in the last 3 months? (5 years for LEI kites)
- Does the damage appear to be attributable to defective materials or workmanship?
- Does the damage appear NOT to be due to impact, abuse, negligence, or reactions to solvents, or



harsh detergents?

For specific instructions regarding different products, please consult the Product-by-Product Guidelines.

## STEP TWO

Bring the product to the store where it was purchased OR Call Slingshot for a Return Authorization (RMA) Number OR email **warranty@sskiteboarding.com** to obtain an RMA number. Please note that warranty claims will not be processed without an RMA number.

- US Consumers call 1-877-775-4843, International 509-427-4950 or email **warranty@sskiteboarding.com**
- Tell us WHAT you are sending back- describe the product. Please include model, product year and serial number.
- We will also require a digital photo of the product showing the issue.
- Tell us WHY you are sending it back- describe the problem.
- Tell us WHERE you bought the product.
- Record the RMA# and details for future reference.

## STEP THREE

Pack and ship the product immediately!

- Include the original proof of purchase (receipt).
- Include a brief description of the problem and the RA#.
- Mark the defect clearly with a piece of masking tape.
- Print the RA# clearly on the outside of the box.

Slingshot Sports Attention: Warranty  
RA# \_\_\_\_\_ 40 SW Cascade Ave,  
Suite 45 Stevenson, WA 98648

If you live in anywhere outside the United States: Please contact us via email and we will get you in touch with your regional distributor to process your claim. **warranty@sskiteboarding.com**

Customers are responsible for shipping charges to Slingshot. Slingshot is responsible for all charges shipping the product back to the customer or dealer. Street addresses are required. We cannot return ship to a PO Box.

## DISCLAIMER

### SLINGSHOT DISCLAIMER

## **RELEASE OF LIABILITY, CLAIM WAIVER AND ASSUMPTION OF RISK AGREEMENT**

By assembling this product, you are agreeing to: 1) be bound to the terms set forth below; and 2) require anyone using this product to be bound by such terms. If you are unwilling to be bound by these terms, return this product (before use) for a full refund. WARNING: Slingshot LLC® products SHOULD NOT be used in proximity to persons or objects within the radius of a fully extended kite at any time.

### **ASSUMPTION OF RISK**

Use of this product and any of its components involves certain inherent risks, dangers and hazards, which can result in serious personal injury and death. In using this product you freely agree to assume and accept any and all known and unknown risks of injury while using this equipment. The risks inherent in the sport can be greatly reduced by abiding by the Warning Guidelines listed in this User's Guide and by using common sense.

### **RELEASE AND WAIVER OF CLAIMS AGREEMENT**

In consideration of the sale of this product to you, you hereby agree to the fullest extent permitted by law as follows: To waive any and all claims that you have or may in the future have against Slingshot Sports LLC resulting from use of this product and any of its components. To release Slingshot Sports LLC from any and all liability for any loss, damage, injury or expense that you or any users of this product may suffer, or that your next of kin may suffer, as a result of the use of this product, due to any cause whatsoever, including negligence or breach of contract on the part of Slingshot Sports in the design or manufacture of this product.

### **ARBITRATION**

In further consideration of the sale to you of this product and any of its components, you hereby agree to submit to binding arbitration any and all claims, which you believe you may have against Slingshot Sports arising from the use of any Slingshot LLC® equipment. The arbitration shall be pursuant to the rules of the American Arbitration Association. Arbitration shall be commenced within one (1) year from the date on



which any alleged claim first arose. Further, the arbitration shall be held in the state of Washington unless otherwise mutually agreed to by all parties. The submission to the American Arbitration Association shall be limited and the arbitration award may be enforced by any court of competent jurisdiction.

#### **BINDING EFFECT OF AGREEMENT**

In the event of your death or incapacity, this Agreement shall be effective and binding upon your heirs, next of kin, executors, administrators, assigns and representatives.

#### **ENTIRE AGREEMENT**

In entering into this Agreement, you are not relying upon any oral or written representations other than what is set forth in this agreement and User's Guide.



Rider Service Line (toll free in the US): 877-775-4832  
International Telephone: 509-427-4950  
40 SW Cascade Ave., Suite 45, Stevenson, WA, USA 98648